



FEDERAL PUMP CORP

1144 UTICA AVENUE, BROOKLYN, NY 11203



SECTION - 3



SUMP PUMPS



HIGH LIGHT

- 🌀 Pumps can handle up to 2½" spherical solids
- 🌀 Indoor and outdoor installation
- 🌀 Easy installation and removal
- 🌀 For sump and rain water
- 🌀 Control system available
- 🌀 Fiberglass and steel basin available

INTRODUCTION

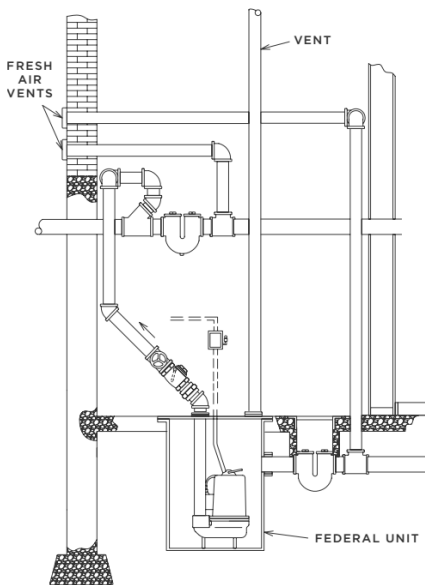
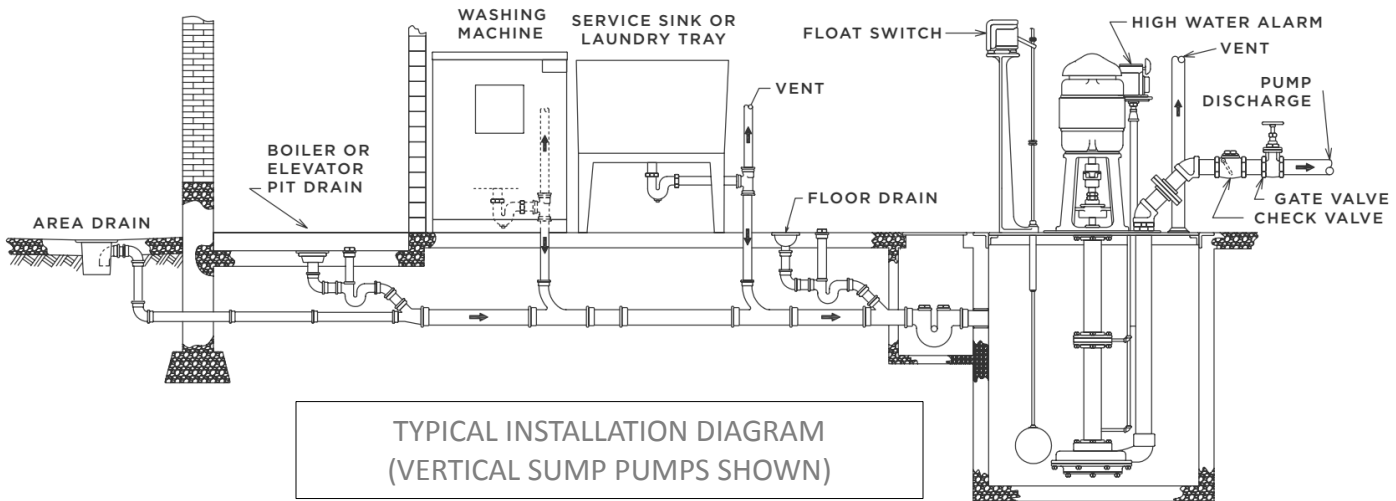

Sump pumps provide for the lifting and disposal of fluids from retaining basins or concrete pits and are pumped to city water disposal lines where these fluids cannot drain under gravity conditions alone. Typically located below grade, sump pumps provide building owners the ability to design and locate floor drains or other facilities below ground that are serviced by these lift stations.

Compatible with Federal Pump's OS, FSS, SBS, TCS, and NPC simplex, and duplex control system, Federal Pump's sump pump series can support 24/7 automatic operation for standard sump pump service in residential and small commercial buildings.

SECTION PERFORMANCE RANGE

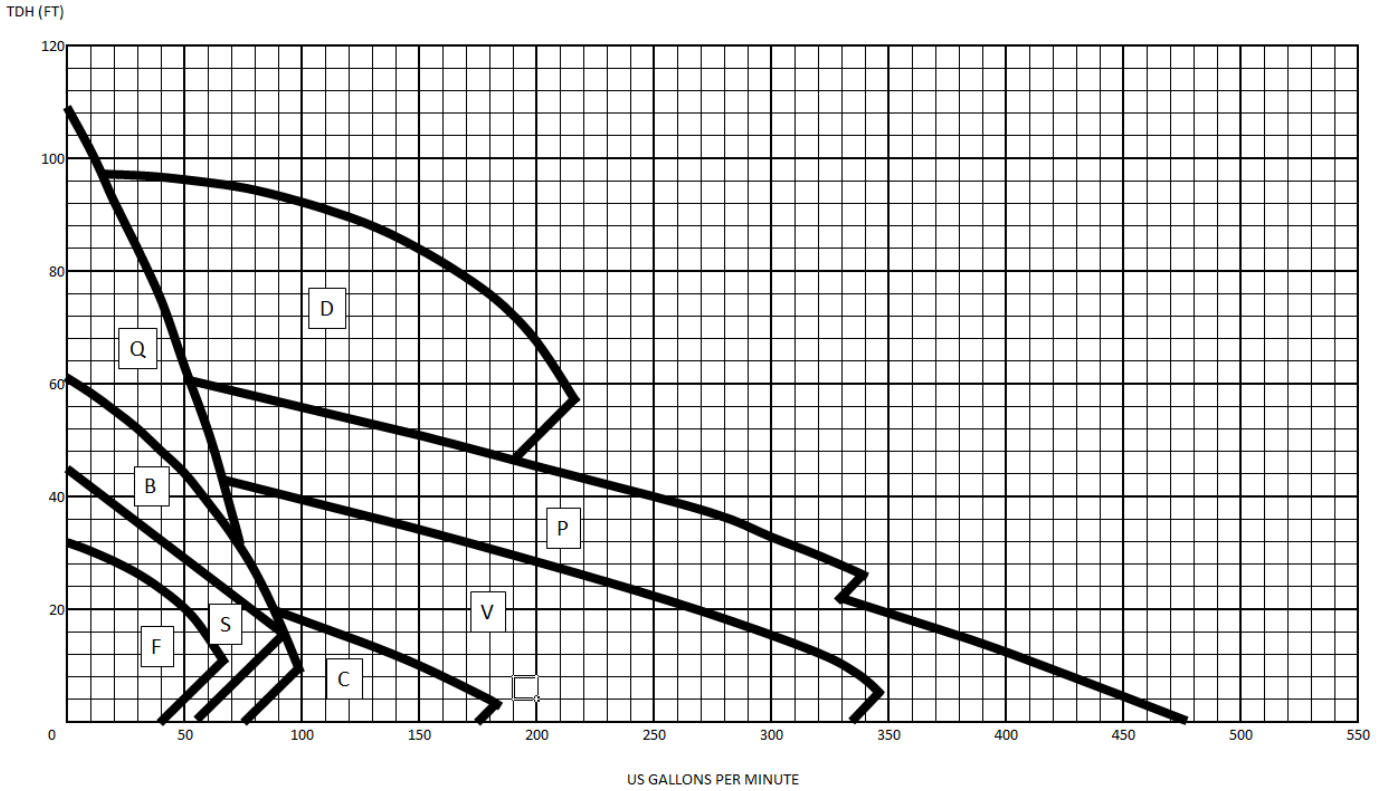

SERIES	ORIENTATION	MAX TEMP. [F]	MOTOR HP	DISCH. SIZE [INCHES]	RPM
B	Submersible	104	½-1	1½-2	3500
C	Submersible	104	½-1	2	3500
D	Submersible	104	1-7½	2½	1750
F	Vertical	180	¼-½	1½	1150/1750
P	Submersible	104	1-3	3	1750
Q	Submersible	104	½-1	2	1750
S	Submersible	104	¾- 1½	1½	3500
V	Vertical	180	½-3	2-3	1150/1750



**Variable Speed Booster
Model VSPV(up to 300 PSI)**

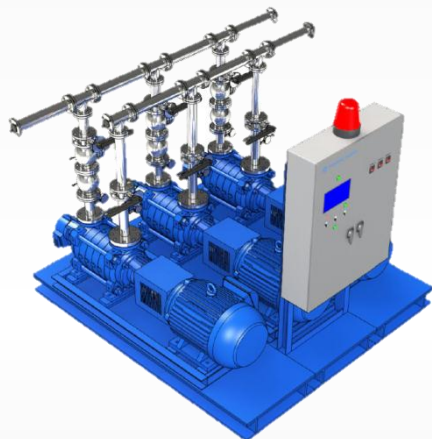

**Variable Speed Booster
Model VSPM(up to 600 PSI)**



**Oil Shield Elevator Sump System
Model SOS(up to 100GPM)**

Since 1927 Federal Pump has been a leading provider of reliable and innovative fluid handling solutions for supply water management and dewatering pump services.

Its recent introduction of the VSPV & VSPM variable speed domestic water supply system combines innovative technological advancements in premium efficient motors and variable speed drive support programs that reduce energy demand, lower operating costs, and provide more finely tuned supply controls.

Its VSA/VSP vertical pump rated to 210F provides solutions in dewatering applications where condensate or boiler feed water are collected and then cooled and pumped to city sewer connections providing continuous service where submersible pumps do not provide a sustainable solution.

The SOS Oil Shield sump pumps alerting building management to potential oil leaks in the elevator areas provide additional building support.

High rise roof fill applications, water make-up systems for mechanical equipment utilizing rain water systems and energy efficient condensate, boiler feed, and vacuum condensate units continue in the focus of energy efficiency and building support.

In the tradition of leadership through product innovation, quality designs, and reliable customer service, Federal Pump continues to be a supplier to those water management and dewatering markets where it first started that tradition of leadership in Brooklyn, N.Y.



**Vertical Sewage/Sump Pump
Model VSA/VSP(up to 1400GPM)**

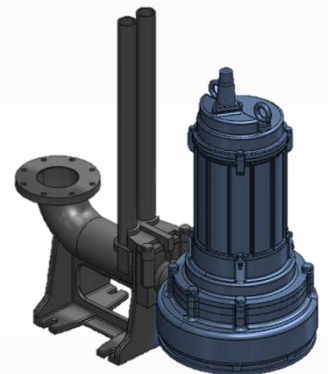

**Submersible Sewage/Sump Pump
Model MSC-QD/J(up to 500GPM)**



1144 Utica Avenue
Brooklyn, N.Y. 11203
Tel: 718-451-2000
www.Federalpumps.com